

pinsetter parts plus
in the challenge to keep things moving

Turret
Ramp & Deflector
See Page 2

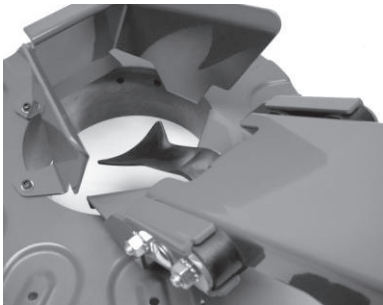

Mounted on 4 of our US made Heavy Duty Shock Mounts, Ramp absorbs pin impacts during delivery and probe blocking.

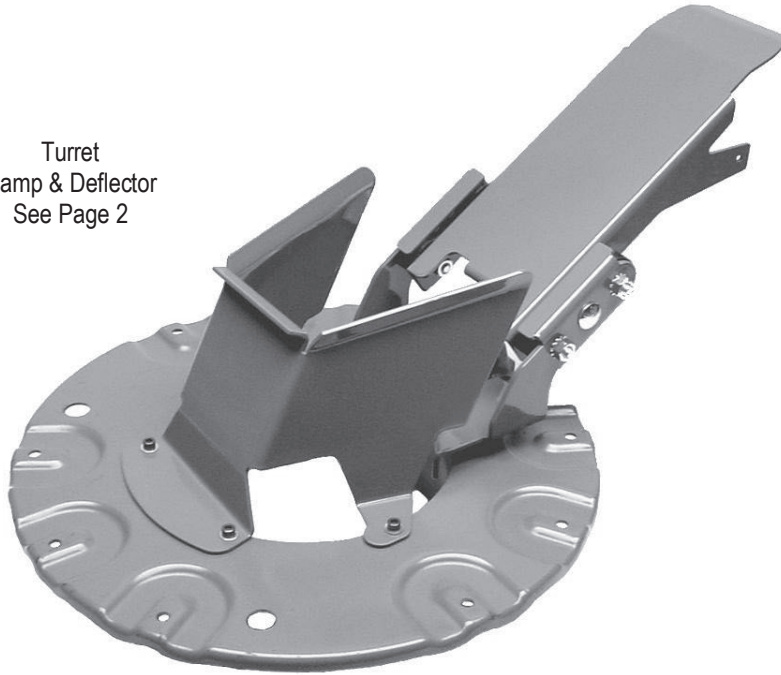
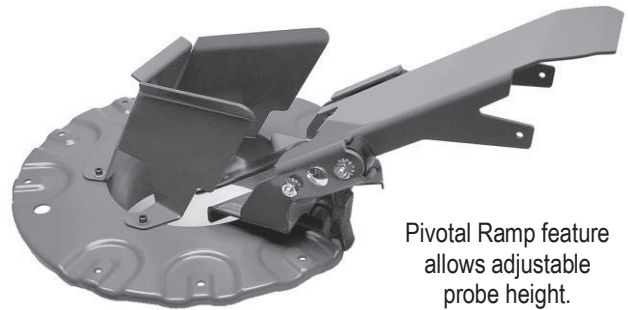

Pivotal Ramp feature allows adjustable probe height. No bending probe to adjust.



US made Pit Conveyor Heavy Duty Shock Mount



Look for Price Reductions throughout catalog. See page 2 for complete list.

2019-2020 Catalog
For Brunswick equipped centers

Look for Price Reductions! (see below) on selected items throughout catalog.

New Products	2
Gear Box	3
Detector	3
Turret	4-5
Deck	5
Pit Cushion	5-6
Pit Conveyor	6
Rake	7
Elevator	7-10
Cross Conveyor	10
Ball Return	10-11
Electrical	11
Miscellaneous	11
Pit End	11-12
Discontinued Parts	12

Turret Ramp and Deflector
 Part No. **PPP-RAD**
 Pkg. of 1

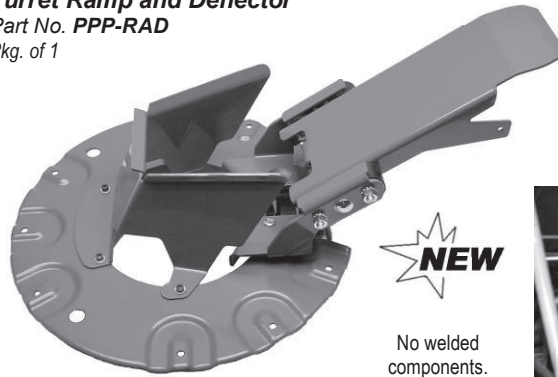

Replaces
 12-150108-000
 Center Chute.



No welded components.



Pivotal Ramp feature allows precise probe positioning in regards to blocking fingers - never before possible.

Troublesome (inside corner) clamp plate screw positions are not used for Ramp mounting.

Smooth quiet operation. Shock Mounts absorb both pin entry and blocked probe vibrations. Greatly reduces chance of probe-involved deck jam damage.

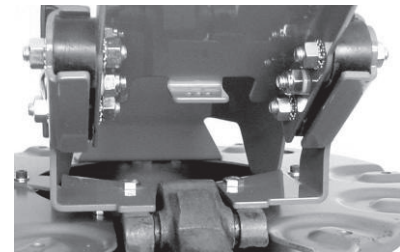

Ramp is suspended on 4 of our US made pit conveyor Heavy Duty Shock Mounts to brackets bolted through existing holes on top of pin release lever casting.

Powder coat finish for a distinctive appearance.

Pit Conveyor Heavy Duty Shock Mount
 Part No. **PPP-HDSM**
 Pkg. of 4

Replaces part # 90-675000

Not getting life expectancy from available shock mounts?

Our rubber shock mounts are US made and offer longer service life.



Made in the USA

Shock Mount Keps Nut
 Part No. **PPP-SMKN**
 Pkg. of 10

Keps locking nuts eliminate the twist and rebound effect while securing and removing pit conveyor rubber shock mounts.



Frameworkx Seating Pin Removal Tool
 Part No. **PPP-FXPRT-2**
 Pkg. of 1

Economical tool, for spring and bearing replacement, in Frameworkx seating. Unseat hard to access pins. See page 15.

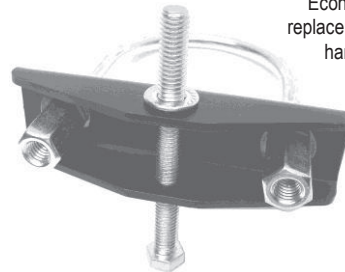

Adjustable Turret Levers – One Wrench Bolt
 Part No. **PPP-ALB**
 Pkg. of 10

Thanks To Doug Schmidt
 Little Falls, MN

This much more economical bolt replaces earlier specially made fastener.

Use nut and washer to draw carriage bolt into lever opening then use your choice of nut and lock washer or lock-nut to secure turret adjustable levers with only 1 wrench.

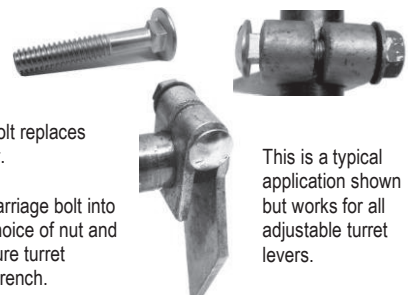

This is a typical application shown but works for all adjustable turret levers.

Gear Box Oil Level Dip Stick

Part No. **PPP-DIP**
Pkg. of 1

Push Dip Stick into oil fill hole at an angular position of about 11:25, until rod hits bottom of gearbox.



Sight glass is often a cloudy unreliable indicator. Add oil when below bottom line.

Safe Level



Full

Dashpot Chain Link Replacement

Part No. **PPP-DCLR**
Pkg. of 1

By Dave Van Haelst
Savanna, IL.

For Converted
Model A's



Convert chain link plunger to A2 type adjustable dashpot.

Keep these on hand and eliminate the headache of replacing the chain link during repairs in this area. Remove model A plunger and drop in this assembly and adjust like an A2.

Detector Timing Tool

Part No. **PPP-DTT**
Pkg. of 1

Tool allows the detector to be removed and replaced in any degree of gearbox rotation preferable to the Service Tech.



Thanks to Jeff Lerner Simi Valley, CA

Automatic Out-of-Range Hook Replacement

Part No. **PPP-HR**
Pkg. of 1

7/8" gap allows for use of the commonly used 8" bench grinder to a width of 3/4" to easily adjust ID of hook-end for proper spacer clearance needed in some pinsetters. Lower image OEM.



Reset Lever Repair Arm

with Installation strap-fixture
Part No. **PPP-RLRA-F**
Pkg. of 1

Price Reduction!

PPP-RLRA-F comes with strap fixture to accurately position (without measuring) repair arm for drilling mounting holes. *Fast and Easy!*

Permanent repair for both single and double armed cracked or broken reset levers in less than 5 minutes and without welding.

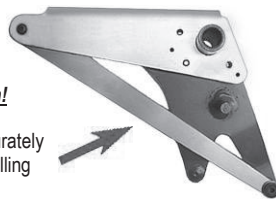

Reset Lever Repair Arm

Part No. **PPP-RLRA**
Pkg. of 1

Price Reduction!

Order PPP-RLRA if you already have an installation strap.

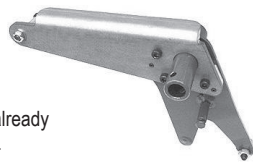

Gear Box – Clutch Cone Saver

Part No. **PPP-CCS**
Pkg. of 5

Durable Nylon 3/16" spacers prevent galling of the clutch cone end and flanged nut by absorbing the vibration between metal parts.



Oil Pan Liner

Part No. **PPP-OPL**
Pkg. of 4

1/4" thick pads will keep oil pans free of heavy grime build-up for many years. Use scissors to cut slit in one end for bracket clearance for wall to wall absorption.



Pear Cam Seal Seating Tool

Part No. **PPP-PCSST**
Pkg. of 1

Install new seals in inaccessible pear-cam shaft housings using hand wrenches.



Thanks To Brandon Jagerson
Marshfield, WI

Automatic Out-of-Range Assistant Spring

Part No. **PPP-AORAS**
Pkg. of 2 springs

Use this spring for consistent automatic out-of-range adjustments.

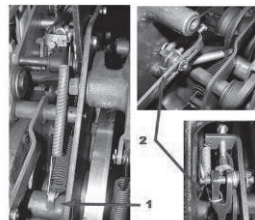

1 Clutch Reset Lever Spring Mounting Hole
2 Detector Out-of-Range Bellcrank Lever

Spring keeps consistent detector bell crank tension against the automatic out-of-range adjustment bolt throughout the entire machine cycle allowing precise hook pivoting over (and away from) the post on the selector arm assembly.

Reversible Moving Deck Cam Follower Shaft

Part No. **PPP-MDCFS**
Pkg. of 1

replaces 12-100104

Snap ring grooves and bolt threads on both ends allow quick turn around times.



Thanks to Marty Murphy
Ft Wayne, IN

First Ball Return Kit

Part No. **PPP-FBRK**
Pkg. of 1

Returns pinsetter to first ball cycle without climbing up onto machine.

Hook can be quickly removed without tools when machine needs servicing.

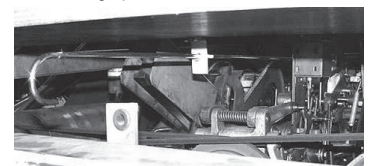

Easy retrieval of ball in front of pit cushion, pinsetter on second ball. Just pull the First Ball Return Hook and hit the reset button.

Slide Plate and Bearing Housing Assembly

Part No. **PPP-SPA**
Pkg. of 1

Price Reduction!



Modified Slide Plate

Easy positioning of slide plate into grooved posts even with all slide plate components fully in place. No need for disassembly when slide plate accidentally slides off grooved slide posts.

Slotted spring guide roll pin ports eliminate unnecessary need for precision (during spring compression) when installing clutch plate parts.

The additional torsion latch spring post roll pin hole (when used increases spring tension) allows extended use of worn time delay gear and torsion latches.

Turret Release Spring Bracket

Part No. **PPP-TRSB** – pkg. of 1

Easy solution for worn spring hole.



Simply place spring through bracket and OEM mounting for original positioning or secure middle hole with bolt and place spring in either neighboring hole for slightly more or less tension.

Pozi Drive Turret Clutch Lining

Part No. **PPP-PDCL**
3 lining strips and rivets

These linings have over 50% more surface to surface contact than OEM - provides more driving power for extended life and better performance.



Adjustable Torsion Latch Bumper

Part No. **PPP-ATLB**
Pkg. of 2



Quickly adjust torsion latch alignment with time delay gear stop.



Self-aligning urethane bumper has 4 sides with 1/16" increments from mounting post for fine-tuning torsion latch depth under time delay gear.

Turret Wire Fastener System

Part No. **PPP-TWFS**
Pkg. of 10

Fastener can withstand the firmest securing without deforming.

Top mounted riser and lock washer allows full bolt head contact with socket or wrench.



No tools needed underneath.

Heavy Duty Probe Spring

Part No. **PPP-HDPS**
Pkg. of 2

50% stronger than OEM springs.

Ensures spoons lock after pins release. Shortening springs can give unexpected results and tying off coils may lead to failure.



replaces 12-150096

Adjustable Turret Levers – One Wrench Bolt

Part No. **PPP-ALB**
Pkg. of 10

Thanks To Doug Schmidt
Little Falls, MN

This much more economical bolt replaces earlier specially made fastener.

Use nut and washer to draw carriage bolt into lever opening then use your choice of nut and lock washer or lock-nut to secure turret adjustable levers with only 1 wrench.

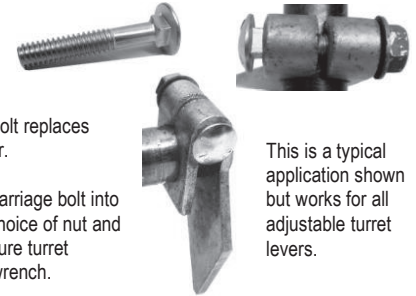

This is a typical application shown but works for all adjustable turret levers.

Broken Interlock Shaft Repair

Part No. **PPP-BISR**
Pkg. of 1

Simply place long hook onto blocking finger and other into bracket and pull onto forward cross conveyor mount bracket.



Pinsetter pictured above, worked with this repair for over 19 years.



Keep one on hand for an emergency.

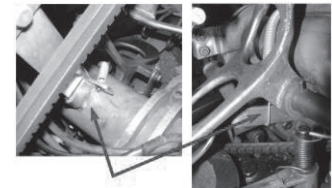

Quick return service - no tools to install. Leave repair in place indefinitely.

Probe Mount Replacement

Part No. **PPP-PMR** – pkg. of 1
Weld mount and Standard Probe Mount



When you're tired of welding probe mounts, try this weld-on 9 gauge bracket with a bolt-on replaceable mount.



Probe Weld Mount

Part No. **PPP-PWM** – weld mount only
Pkg. of 1

A Standard Probe Mount must be available for probe-alignment prior to welding.



Adjustable Probe Mount

Part No. **PPP-APM**
Pkg. of 1

Adjustable probe height.



5 Chute Mount Reinforcement

Part No. **PPP-5CMR**
Pkg. of 2 straps & mounting screws

Repair broken 5-chute clamp plate corners with these heavy duty 10 gauge Reinforcement Straps. Install Reinforcement Strap to prevent clamp plate corner breakage from occurring.



Heavy Duty Blocking Finger Spring

Part No. **PPP-HDBFS** (replaces 12-150213)
Pkg. of 1

75% stronger than OEM - eliminates the need for multiple springs on restricted drop blocking finger.



Thanks to Jamie Cecil
Plymouth, MI

Bell Crank Stud Hole Repair

Part No. **PPP-BCSHR**
Pkg. for 2 hole repairs*

*Bell Crank Stud shown for point-of-reference and is not included.

Thanks to Jim Seay - Lawrenceburg, TN



Quickly restore precise bell crank stud position in elongated turret frame mounting hole. Large diameter washer fits perfectly into milled recess of turret frame to center stud in its original position.

Place small diameter washer onto stud. Insert stud in turret frame and place large diameter washer on stud and secure with included lock nut.

Moving Deck Cable Spring Master

Part No. **PPP-CSM**

Slotted tube and 2 pac-man spacers

Spring prevents cable slack at rear most position of deck during pin spotting. Over time, cable adjustments affect spring ability to stay on the lower spring keeper.

Shown at right, 1/4" spacers allow to determine proper height so spring stays centered on keeper. Properly spaced spring stays on keeper.

Pac-Man Spacers

Part No. **PPP-PMS**

Pkg. of 2 spacers



7 & 10 Deck Roller Spacers

Part No. **PPP-DRS**

Pkg. of 2

Occasional unexplained pin jam in the 7 or 10 bucket?

Install Spacer to eliminate the possibility of pin bottom being caught momentarily on the side of deck roller causing delayed pinsetting leading to no-power conditions.

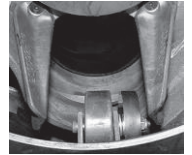

Install urethane spacer to the kickback side of the 7 and 10 deck roller positions.

Deck Roller Shoulder Bolt

Part No. **PPP-DRSB**

Pkg. of 2

O-rings provide tension to shoulder bolt preventing hole wear from turning - cost less to replace than x washer and pins.



Deck Shield Bracket

Part No. **PPP-DSB**

Pkg. of 1

10 ga steel bracket is an economical replacement for OEM upper rear brackets where mounting bolt is broken in casting.

Thanks To Brandon Jaerson, Marshfield, WI



Deck Cable Spring Mount Repair

Part No. **PPP-CSMR**

Pkg. of 1

Quickly restore worn away deck cable spring mountings. Unscrew allen fastener far enough to slip on repair bracket.



Deck Shield Slide Bracket

Part No. **PPP-DSSB**

Pkg. of 1

Repair for sheared front mounting bolts.

Bracket with plastic base allows front of shield to glide freely on deck and reduces chance of rear shield brackets breaking.

Front shield support is important in keeping shield from sagging and allowing contact with pit light.



Pit Cushion Service Fixture

Part No. **PPP-PCSF**

Pkg. of 1

Slim design, fixture supports pit cushion weight allowing easier servicing of links or Cam and Rollers. Slotted pedestal holes adjusts to any cushion height.

Plenty of work-around room - both 7 and 10 sides can be easily serviced at the same time.

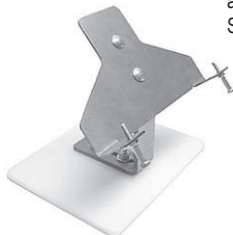

Used as a bench mount - holds cushion at a nice working angle for welding.

Heavy Duty Curtain Rod Holder

Part No. **PPP-HDCRH**

Pkg. of 1 RH-LH pair

Secured wrap around design ensures against loosening, bending, and breaking.



Cushion Shock Mount Pin Deflector

Part No. **PPP-CSPD**

Pkg. of 1

Prevents head of pin being caught between ball wheel and shock mount.

1 1/2" minimum distance between ball wheel and cushion shock mount edge required. Pins do not get caught when elevator assy installation is closer.



Curtain Rod Holder Insert

Part No. **PPP-CRHI**

Pkg. of 1

Urethane insert fits our Heavy Duty Curtain Rod Holder - Part No. **PPP-HDCRH**



Eliminates rubber rod ends.

Smooth-Faced PVC Pit Cushion Cover
Part No. **PPP-CCA2**
Pkg. of 1

Covers have installation *holes for easy accurate centering alignment. Easy pull back corners for access to front of cushion mount bolts and ample rear cushion mount working room without having to remove nylon cable ties.

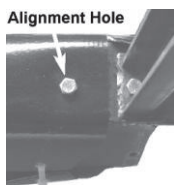

Alignment Hole

*Please note; replacement pit cushions may not have the additional ledge holes beyond curtain rod holder.



Work Space

Comfortable cushion mount work-around-room without removing cable ties - front cover corners easily pull away for easy tool access to mounting bolts.

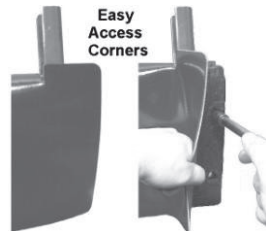

Easy Access Corners

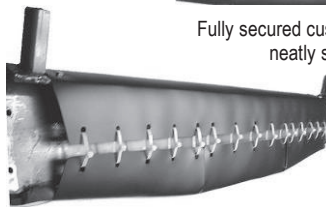

Close seams greatly reduce ball impact twist-effect and allow leaving old facing in place for additional cushion rubber protection.



Fully secured cushion cover close-seams for a neatly secured appearance.

Close joining seams reduce area for pins to land on and use shorter much less expensive cable ties.

Cushion Mount Bolt Stabilizer Bracket

Part No. **PPP-CMBSB-LH** (7 Side)
Part No. **PPP-CMBSB-RH** (10 Side)
Pkg. of 1

This steel bracket will keep the 1/2" cam bolt from wobbling even if bolt loosens allowing time for correction during normal machine maintenance.

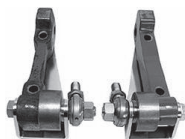

Mounting example above. Designed for our Pit Cushion Cam & Roller Kit

PC1K UPGRADE + mounting hardware

Part No. **PPP-PC1K-UP**
Pkg. of 1 kit

Patent No. 7,115,040

Impact resistant maintenance-free roller hub. No lubrication needed. Energy Absorbing Roller and Delrin® Cam



Replacement Roller

Part No. **PPP-RRA-NM**
Pkg. of 1



With Maintenance-Free Hub

Replacement Inner Roller Sleeve

Part No. **PPP-RIRS**
Pkg. of 2

Installs directly over roller mounting bolt.



Cushion Weld Plates

Part No. **PPP-CWP**
1 RH-LH pair

1/4" steel plates.

Thanks to Jamie Cecil Plymouth, MI



Convenient central 1/2" holes allow welding access to inner area for added strength. Longer mounting hardware included.

Nylon Cushion Link

Part No. **PPP-NCL**
Pkg. of 1

replaces 12-252069

High strength, wear resistant, low friction self-lubricating Nylon 6/6.



Pit Conveyor Frame Weld Plates

Part No. **PPP-PCFWP** - set of 4 plates - 1 ea #1 and 2 plates - 2 #3 Plates



Plate 1 - Bottom View



Plate 1 - Top View

Plate 1 - wedges between center post and radial tubes.



Plate 2 - Bottom View

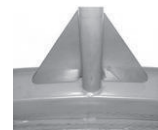

Plate 2 - Top View

Plate 2 - cradles center post providing additional strength.

10 gauge weld plates span beyond fatigued metal and original welding.



Plate 3 - Top View

Plate 3 - unique shape allows welding onto frame area not affected by fatigue.

Pit Board Shim

Part No. **PPP-PBS**
Pkg. of 2

Place shim between front pit board edge and upper frame clamp. Keeps pit boards firmly in place.

57" long by 1-3/8" deep and 1/4" thick. Rugged recycled tire rubber resists deforming and with anti-skid properties keeps pit boards in place.

Quick Release Frames - cut into 4 inch strips and place one on each end between board and release clamps.



Pit Conveyor Frame Threaded Hole Repair

Part No. **PPP-PCTHR**

Pkg. of 1

Repair can easily be done in back room or take to welding service.



Threaded Hole Repair is machined 4130 hard steel and will further harden during welding for long wear and thread life.

Center Mount Pit Board Bumpers

Part No. **PPP-PBB**

Height from top of tube 1-1/4"

Pkg. of 1

Part No. **PPP-PBB-S**

Height from top of tube 3/4"

Pkg. of 1

Center mounting reduces chance of bumper shaking off.



Jogger Mount Repair Plate

Part No. **PPP-JMRP**

Pkg. of 2

10 gauge weld plate spans missing pieces and fatigued metal.

Welding fatigued pieces back together usually results in a short repair life.

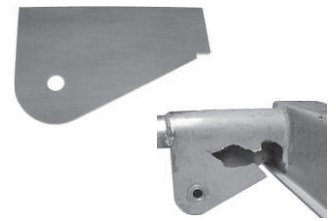

Upper Shaker Frame Weld Plate

Part No. **PPP-SFWP**

Pkg. of 1

Prevent breakage commonly seen in quick-release upper shaker frames with this reinforcement weld plate. Use to repair ones already cracked or broken.



Thanks to Jamie Cecil - Plymouth, MI

Economical - Wheel Guard - Broken Mounting Bracket Repair



Broken OEM bracket example



Repair in position

Wheel Guard Mount Assembly

Part No. **PPP-WGMA** - pkg. of 1

Mounting Plate welded to Bracket Replacement. Drill and tap 3/8" mounting hole in pinsetter frame stub remains.



Thanks To Brandon Jagerson Marshfield, WI

Wheel Guard Mounting Plate

Part No. **PPP-WGMP** - pkg. of 1

Weld to existing original broken bracket.



Wheel Guard Replacement Bracket

Part No. **PPP-WGRB** - pkg. of 1

For missing broken OEM brackets - arrange for your own welding to Mounting Plate.



Rake Return Pivot Repair

Part No. **PPP-RRPR** - pkg. of 1

Easy to install pivot repair allows adequate room for spring tube operation without binding.

Thanks To Doug Schmidt Little Falls, MN



Rake Return Pivot Repair

Drill Guide

Part No. **PPP-PRDG** - pkg. of 1

Easily drill holes for Rake Return Pivot Repair mounting.

After removal OEM pivot bearing holder, clamp into position with vice grips and drill two 5/16" holes in flange image far right.

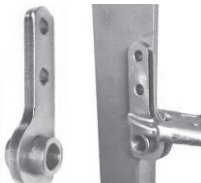

Slotted Pivot Glide

Part No. **PPP-SPG**

Pkg. of 2

Excellent triggering properties. Eliminates the need to block the C bracket to prevent trip rod lever from inverting. Do both pivot slots or just the trip rod side. Replaces urethane pivot roller.



Rake Board Stress Relief Kit

Part No. **PPP-RSRK**

Pkg. of 2

Steel reinforcements prevent fiberglass hole blowout. Put badly damaged boards back into service.



Fast & Easy - Rake Shaft Repair

Part No. **PPP-RSR** (for all rake shafts)

Pkg. of 1 repair kit

No holes to drill - Return to service in 5 minutes - Reusable.



Lower Ball Wheel Roller Stud Wrench

Part No. **PPP-LRSW**

Pkg. of 1

Corners machined allowing to quickly find insert-center of the blind entry recessed bolt.

8 inch handle easily loosens and tightens without additional leverage tools. When Button Head is felt slipping into bolt entry point, rotate tool to engage wrench corners.



Rubber Lower Ball Wheel Grooved Roller

Part No. **PPP-HUB-G** - pkg. of 1

(replaces 90-400260-000)

Great Price Reduction!

Softer composition rubber roller reacts to steel ball wheel diameter variations and absorbs bowling ball under lift rods contact for smooth quiet performance. Rubber ages better than urethane (resists fragmenting) and reduces stress on aging ball wheel joint welds.

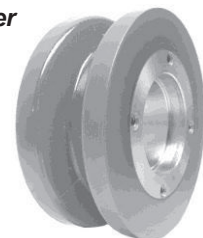

Rake Shaft Hanger

Part No. **PPP-RSH**

Pkg. of 1 pair

Price Reduction!

Hangers supported by rake lift tube conveniently holds rake shaft during rake shaft removal and replacement.



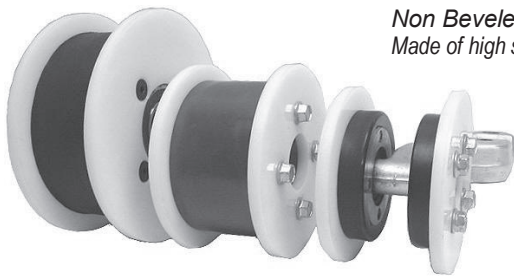

*Non Beveled Edge - Ball Wheel Roller Flanges.
Made of high strength Delrin® low friction-wear resistant-reduced flexing.*

Straight edged flanges
Reduced ball wheel wobble.
Extended wear before replacement.

Example right
PPP-NBBWF
replaces 12-402107

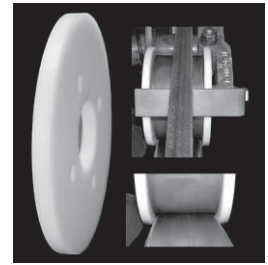

Heavy Duty Lower Ball Wheel Roller Flange - upper left
Part No. **PPP-HDLRF** - replaces lower roller flange 2-400257
Pkg. of 1

PPP-HDLRF is 1/4" larger diameter than OEM

No Bevel Upper Ball Wheel Roller Flange - middle
Part No. **PPP-NBBWF** - replaces upper HD roller flange 12-402107
Pkg. of 2

PPP-NBBWF is the same diameter as OEM

No Bevel Upper Ball Wheel Roller Flange - far right
Part No. **PPP-NBGRF** - replaces small roller flange 12-400269
Pkg. of 2

PPP-NBGRF is 3/8" larger diameter than OEM

Serrated Flange Screw
Part No. **PPP-SFS**
Pkg. of 10



Positive securing of ball wheel roller flanges not using counter sunk holes.

Adjustable Ball Wheel Idler Spring

Part No. **PPP-ABWS**
Pkg. of 1

for A and A2



OEM spring over-strain ball wheel belt - little tension is needed (with no slippage) to turn the ball wheel.

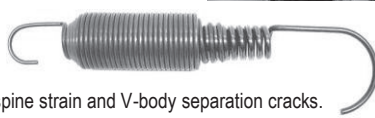

Extend belt life by greatly reducing spine strain and V-body separation cracks.

3" variable adjustment at 1/8" increments per 1/2 turn for individual ball wheel tension.

Ball Wheel Pin Deflector

Part No. **PPP-BWPD-WG - with gum rubber**
Pkg. of 1 rod angle, 1 adjustable mount, 1 hose clamp, 1 1 1/2" gum rubber tube



Save money, use gum rubber from your own roll *
Part No. **PPP-BWPD-NG - without gum rubber**
pkg of 1 rod angle, 1 adjustable mount, 1 hose clamp

Thanks to
Dave Van Haelst
Savanna, IL.

Greatly reduces or eliminates pins in upper ball track and on floor behind pinsetter. Can be placed in an infinite number of positions to suit individual preferences. Mount in existing hole (enlarge hole size to 7/16") in rear pin guard below and to the right of lift rods mounting shaft.

*For best results, use Brunswick gum rubber. Other gum rubber generally may be less rigid and require additional effort in obtaining good results.

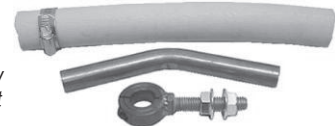

The Original - Pozi-Grip Pozi-Guard

Part No. **PPP-PG1**
Pkg. of 2

Outperforms all competitor products.

Recommended for high conditioner carry down conditions such as in Guardian surfaced centers.

Only one Pozi-Grip recommended per machine to reduce ball return stops.

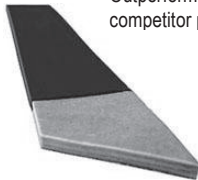

Pozi-Grip II - Lower Profile than PPP-PG1

Part No. **PPP-PG2** Recommended for synthetic lane surfaces.
Pkg. of 2

Outstanding Performance

Lower profile where less surface contact with traction material is needed to carry balls up lift rods.

Only one Pozi-Grip II recommended per machine to reduce ball return stops.

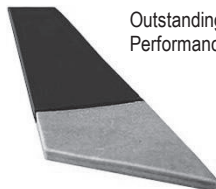

Premium Pozi-Guard Replacements

Part No. **PPP-PPGN** Replacements for PPP-PG1 and PPP-PG2
Pkg. of 4

Pozi-Guard protects Pozi-Grip by preventing damage to materials leading edge and prolongs life span.

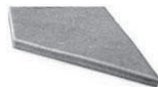

Adhesive Backed Roll Stock

Part No. **PPP-RS - 10' roll**

High-quality roll stock ideal for ball wheel conditions requiring the use of traction materials. Long term economy - less material needed to achieve satisfactory results.



Economical Cork & Rubber Composite Ball Wheel Traction Material

Part No. **PPP-CTM - 25 ft Roll**

Another adhesive backed option in our specialized line of ball wheel traction materials.



Pin Wheel Pin Wiper Cushioned Spring Support

Part No. **PPP-PWS**
Pkg. of 1

Choose position for more or less support and height for best results to reduce turn pan jams.

Bumpers have 3 threaded mounting hole choices. Rubber topped adjusters for a smooth and stable pin wiper performance.

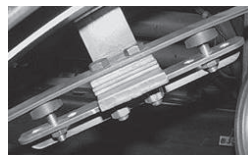

Modular Pin Wheel Pocket Stabilizer

Part No. **PPP-MPWPS**
7 re-enforcement ribs

By Tom and Mark from Missouri



Steel ribs reduce pocket flexing that can trap pins leading to late turn pan delivery. Stabilizer ribs increase plastic pin wheel diameter to nearly that of the steel pin wheel eliminating the need for pin wiper re-adjustments.

Adjustable Pin Wheel Brake Tension

Part No. **PPP-ABT**
Pkg. of 1

Greatly improves pin wheel braking.

Newly installed belts do not always brake properly. Choice of holes allow for just the right tension on pin wheel belts.

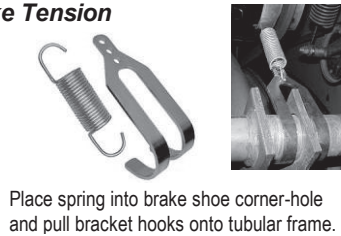

Pin Wheel Sound Dampener

Part No. **PPP-PWSD**
Pkg. of 1

Spring and cable loops are tucked out of the way into pocket area.

Held in place with a spring, easy to install 1/4 inch steel cable reduces pin wheel noise.



Ball Lift Rods Stud Replacement Kit

Part No. **PPP-BLSRK**
Pkg. of 1

After installation, it is no longer necessary to remove spring rod and collars to replace ball lift stud.



Great Price Reduction!

4 3/4" Ball Lift Rods Stud

Part No. **PPP-BLSRK-S**
Pkg. of 1

Thanks to Mike Hennick Pleasant Hill, IA

One inch shorter stud greatly reduces or eliminates occasional ball sitting on top of lift rods. Decreases spreading of rails for increased upward ball speed to reduce chance of ball yo-yo. Improves overall lift rods performance.



Pin Wheel Brake Lining

Part No. **PPP-PWBL**
Pkg. of 1

Install without removing worn brake.

Slide new steel lining between belt and worn brake and secure.



Pin Wheel Pin Positioner

Part No. **PPP-PWPP**
Pkg. of 1

For quieter operation, eliminates piggy-back and possible 2 pins-in-wiper jams.

Easy mounting in rear plate existing hole. Improves plastic pin wheel performance.

Positioned below the rear plate mount (square tube) horizon, rubber mounted angle fully seats pins before ascending to wiper to assist pin wheels with worn or missing buttons.

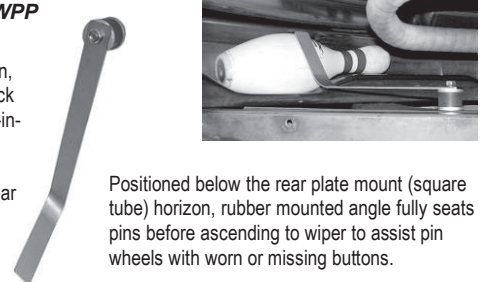

Adjustable Lift Rods Torsion Spring

Part No. **PPP-ALRTS**
Pkg. of 1

Patterned after the long turret belt spring, allows for increased downward pressure to help elevate troublesome-starting bowling balls high enough for spring rod engagement to carry ball onto upper track.



Hooks over lift rods stud and supplied lower spring holder. Over 3 inches variable adjustment.



Heavy Duty Lift Rods Spring

Part No. **PPP-HDLRS**
Spring & 6 PPP-SPSB segments

Economically add greater tension to help prevent ball Yo-Yo. Tune up lift rods with this Heavy Duty Spring and our Spring Post Segmented Bumper.



Clapper Adjustment Screw Stabilizer

Part No. **PPP-CASS**
Pkg. of 1

1 1/4" diameter base distributes lift rods weight more broadly across spacer. Stabilizes set screw - reduces bending and breakage due to small contact area on lift rods spacer.



Thanks to David Ibanez - Hollywood, CA

Lift Rods Spring Post Segmented Bumper

Part No. **PPP-SPSB**
Pkg. of 12 segments

Place as many or few segments needed for best spring rod adjustment.

Six segments equal one-piece urethane bumper, shown at right, at half the cost.



Lift Rods Bench Mount

Part No. **PPP-LRBM**
Pkg. of 1

Unobstructed work area for gum rubber replacement.

Thanks to Dennis Zink West Des Moines, IA.



Easy access servicing clapper box components remount vice flanges on opposite side of tool.

Remove the height adjustment screw from clapper box and secure under tool with supplied bolt. Place mounting flanges into bench-vice.



"Tool made the easiest and quickest lift rods gum rubber replacement I've done in 30 years". Mike, Des Moines IA.

Lift Rods Repair Shaft

Part No. **PPP-LRRS**
Pkg. of 1

Install without welding. Keep one on hand for emergencies.



Tapered connection point diameter is greater than box beam openings and wedges repair shaft firmly in place. 5/8" draw bolt and Nord-Lock® locking system.

Bevel Gear Turret Drive Conversion

Part No. **PPP-BGTDC**

Pkg. of 1 kit

Economically priced, this method of power transfer less costly and easier to maintain. Kit has everything needed to convert bevel gear turret drive to idler pulleys.

Pre-mounted glass-filled Nylon idler pulleys.
Drive pulley, belt and mounting hardware.



By Jamie Cecil - Plymouth, MI

Bevel Gear Turret Drive Conversion – Bracket Only

Part No. **PPP-BGTDC-B**

Pkg. of 1

Bracket design allows converting bevel gear turret drive to idler pulleys using commonly found parts (of your choice) to complete the conversion.



Turnbar 2
Part No. **PPP-T2**
Pkg. of 1

Turn bars ensure base-first turn pan pin orientation reducing or eliminating turn pan jams and headfirst pin delivery.

Made of heat-treated alloy steel, T2 will not bend or deform in any turn pan issue.

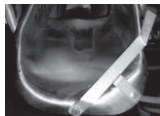

Economical - Non-Aligning Jack Shaft Bearing

Part No. **PPP-JSB** (replaces 10-43001-000)

Pkg. of 2

Economical - Most jack shaft replacements only need one self-aligning bearing and in some cases, where bearing entry-port alignment is good, both bearings can be non self-aligning.



Get 2 jack shaft bearings for less than the price of 1 self-aligning bearing.

Micro Switch Extended Actuator

Part No. **PPP-MSA**

Pkg. of 1

Extended Actuator disengages sooner and re-engages later than round roller.
Replaces original roller.
No readjustment needed.

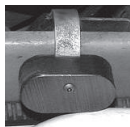

Pins on cross conveyor get pushed around while waiting for turret. Occasional micro switch bumping can cause pin wheel to creep forward allowing unwanted pins onto cross conveyor.

Snubber Tamer

Part No. **PPP-ST**

Pkg. of 1

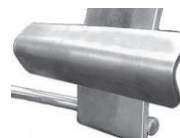

Eliminates chance of pin caught in halo ring making it unnecessary to "fine tune" tops of turret wires and forces pin bottom more squarely onto index lever for improved triggering. Reduces pin bounce as pins drop into turret wires.

Reduces chance of pin getting pushed on top of turret wires as snubber is secured in rear-most position allowing pins to fall from cross conveyor sooner.

Cross Conveyor Belt Adjustment Tool

Part No. **PPP-CCAT**

Pkg. of 1

For ease of tensioning cross conveyor belts.



Cross Conveyor Pozi-Plate

Part No. **PPP-CCPP**

Pkg. of 1 plate & 6 springs

Lexon plate fastens to cross conveyor with tension springs. Applies downward pressure eliminating pin slippage.



Pozi-Plate Tension Springs

Part No. **PPP-PPTS**

Pkg. of 6 springs

Fine tune Cross Conveyor Pozi-Plate pressure.



Cross Conveyor Micro Switch Bumper

Part No. **PPP-CCSB** (replaces 12-450055)

Pkg. of 2

Bolt-on bumpers won't fall off like stick-on ones do.



Cross Conveyor Micro Switch Actuator Limit

Part No. **PPP-SAL**

Pkg. of 2

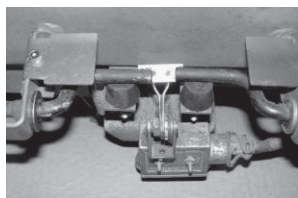

Prevents micro switch actuators from being pushed beyond cross conveyor walls.

Pin Gate & Latch Nut Plate

Part No. **PPP-PGL-NP**

Pkg. of 1

Thanks to
Mike Hennick - Pleasant Hill, IA
Chuck Bashak - Tavares, FL



Repair elongated x-washer pin mounting holes. Ensure parts rotate on bolt rather than pins rotating in mounting holes. Easy access service with Allen wrench.

Shoulder bolts replace x-washers and pins for easy service access with Allen wrench on the gear box side of cross conveyor.

Adjustable Bolt-On Full-Contact Y-Switch Bumper

Part No. **PPP-FCYSB**

Pkg. of 3

Add or remove washers for accurate ball entrance into accelerator or booster. Place unused washers on other side of stop bar for nut backing and future adjustments.



Ball Return

Electrical

Miscellaneous

Pit End

Preference Rod Brake

Part No. **PPP-PRB**
Pkg. of 2

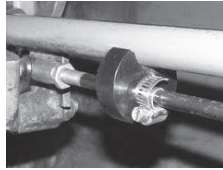

Keep trip levers from popping back up. Rotate urethane brake onto preference rod. Position closer to unibal for more braking power or farther away for less. Secure position with clamp.

Y-Switch Spacer

Part No. **PPP-YSS**
Pkg. of 5



3/16" nylon spacers provide better pivoting surface than a handful of oversized washers.



Solenoid Plunger

Part No. **PPP-SP**
Pkg. of 1

SP and SP-U have more steel below hole allowing more wear.



Undersized Solenoid Plunger

Part No. **PPP-SP-U**
Pkg. of 1

Great Price Reduction!

Fast remedy for tight fitting solenoids.

Ball Booster to Light Bar Step

Part No. **PPP-LBS**
Pkg. of 1

Thanks to Ken and Ron Scranton. PA



Provides a sturdy platform to safely step between ball booster and pit light bar. Mounts to existing holes in pit light mounting channels.

Starter Block Ramp

Part No. **PPP-SBR**
Pkg. of 2

Thanks to Stan Schiltz Des Moines. IA

Smoother lane machine transfers and less jarring of expensive machinery and adjustments.

Mount this 1/8" steel plate over starter block against beveled approach edge.



From this
←
To this
→



2000 Power Lift Hood Insert

Part No. **PPP-HI**
Pkg. of 2

Replace cracked and broken hood inserts at a fraction of OEM cost.



Replacement Reflectors

Part No. **PPP-RR1**
Pkg. of 2

Replaces 57-860507

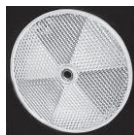

For all triggering systems using center mounting reflectors.

Center mounting reflector measures 3 1/4".

Y-Switch Delta Plate

Part No. **PPP-DP**
Pkg. of 1

Replaces 12-502328



Smooth ball transition from track to accelerator. No X washers or other fasteners needed. Simply lift Delta Plate from y-switch spacers.

3 Amp Circuit Breaker

Part No. **PPP-3ACB-A**
Pkg. of 1

Thanks to Jamie Cecil Plymouth, MI

May require modification to fit converted As.

Convert costly Fustats into resettable 3 amp circuit breakers for American A and A2.



3 Amp Circuit Breaker

(Japanese mounting)
Part No. **PPP-3ACB-J**
Pkg. of 1



Reduces trouble shooting time.

Frameworkx Seating Lightweight Pivot Spring

Part No. **PPP-FXPS-RH** – pkg. of 1 (replaces 53-400124)
Part No. **PPP-FXPS-LH** – pkg. of 1 (replaces 53-400125)

60% spring-power reduction eliminates customer complaints. Seating parts and spring-life greatly increased by greatly reducing seat retraction impact.



Frameworkx Seating Heavy Duty Swivel Bearing

Part No. **PPP-FXSB** (replaces 53-861055)
Pkg. of 1

Thanks to Mike Hennick - Pleasant Hill, IA

Made of Nylon 6/6, these bearings have twice the shoulder height as OEM (at right) to insure bearing stays seated in tube for longer bearing life.



Frameworkx Seating Pin Removal Tool

Part No. **PPP-FXPRT-2**
Pkg. of 1

Economical tool, for spring and bearing replacement, in Frameworkx seating. Unseat hard to access pins.

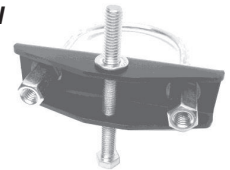

Heavy Duty Pin Removal Tool

Part No. **PPP-FXPRT**
Pkg. of 1

Thanks to Mike Hopkins, Kearney NE

For spring and bearing replacement - unseat hard to access pin in Frameworkx seating



Seating Pin Extractor Tool

Part No. **PPP-FXPET**
Pkg. of 1

Non-marring tool fully extracts remainder of pin from seating without producing shaft burrs.



Premium Gray Fiber and Phenolic Brown 15X33" plates both feature a 45 hole pattern (PPP-FKB-R and PPP-PKB-R - 42 hole-pattern) providing excellent span-tension, between fasteners, for optimum pin-bounce from kickback plates. Predrilled countersunk securing with 1" coarse-thread drywall screws. Install with power drill setting of 9 to 11 for effective securing.

Premium (Gray) Fiber Kick Back Plates



Part No. **PPP-FKB**
15X33" pkg. of 1

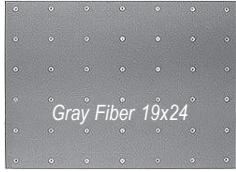

Part No. **PPP-FKB-R**
19X24" pkg. of 1



**Coarse Thread
1" Drywall Screw**
Part No. **PPP-CTDS**
box of 100



Phenolic (Brown) Kick Back Plates

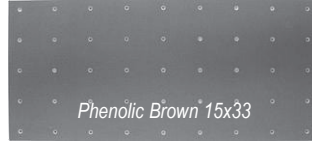

Part No. **PPP-PKB**
15X33" pkg. of 1

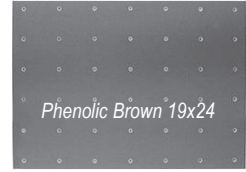

Part No. **PPP-PKB-R**
19X24" pkg. of 1

Steel Rear Kick Back Plate

Part No. **PPP-SRKP** (22X 19")
Pkg. of 1

Steel rear plate is a quick fix for damaged wood kickbacks. Radius edges, recessed mounting screw holes and a durable gray powder-coat finish.

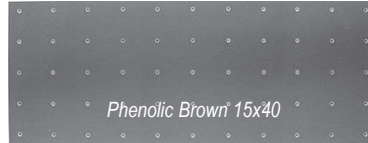

Phenolic (Brown) – for Armor-Plate Kick Backs
Part No. **PPP-PKB-40** 15X40" pkg. of 1

PPP-PKB-40
Features a
55 counter-sink
hole pattern

Rear Kick Back Exposed Wood Cover

Part No. **PPP-RKBC**
Pkg. of 1

Cover gouged wood and holes to prevent further damage. Cover undamaged kickbacks to prevent damage. Mount behind rear plate and below upper shaker frame to span pin pass-by area.



Recycled 1/8" UHMW panel measures 10 X 19", generously sized to fit most applications. Can be easily cut and trimmed to suit individual kick back situations.

No-Slide Pin Spot

Part No. **PPP-NSPS**
Pkg. of 9 spots



**Acceptable for use in USBC
Certified Bowling Centers**

Patent No. 7,704,152

No-Slide Pin Spot will not interfere with normal ball or pin action.

Won't break down under normal bowling lane maintenance.

Peel and apply the clear adhesive backed No-Slide Pin Spot according to instructions.

Pinsetter Parts Plus LLC Performance and Specialty Parts

Thank You for Your Support - pinsetterpartsplus.com

Alphabetical

Discontinued Part Numbers

PPP designation omitted for ease of reference.

289	CMSC	HDWW	RRA
290	CPH-2	HHSS	RRS
1ACB	CPP	HUB	RSC
ATDMC	CPR	JSBT	SE
BDSR	DPG	NSG	SE-J
BFT	EPGN	PC1K	T1
BTR	EBWT-B	PLSB	TDAR
BTR-25	EBWT-R	PPC	TDT
BTR-50	GCS	PPGN-1	TSP
BWBG	GP	PS-1	UNI-NM

Above parts are no longer available.